

Madou - Saint-Josse

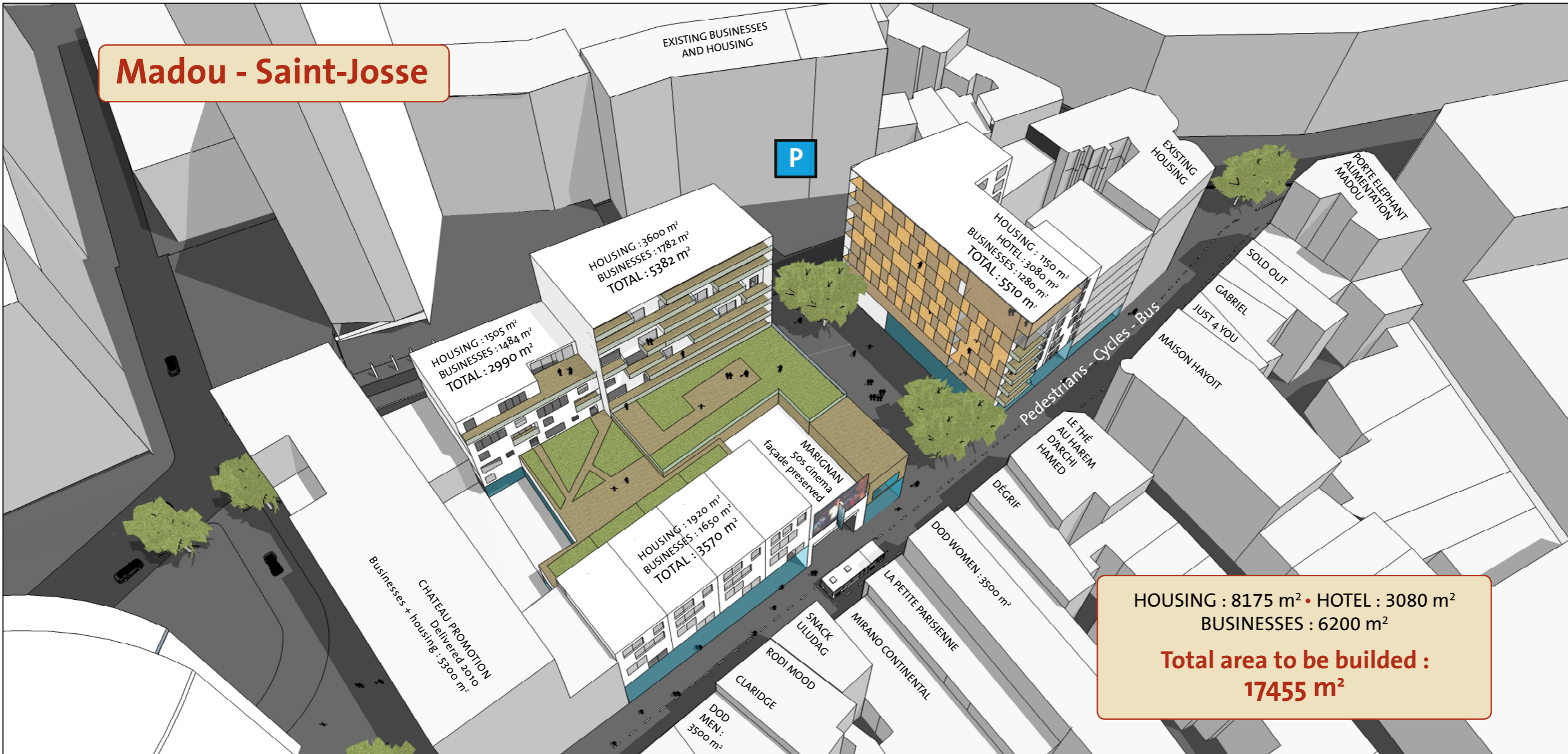

A LIVELY, CLOSE AND ACCESSIBLE DISTRICT

Saint-Josse is a neighbourhood which is rich in tradition, with a thriving business and shopping area. It has a strong identity, with a rich mixture of cultures and activities, where inhabitants and employees, customers and night owls rub shoulders. It is a lively part of the city, the link between the city centre and the European district, where the Madou Tower has for several years housed part of the European Commission's offices.

Atrium and the commune of Saint-Josse have studied the feasibility of a mixed project: businesses, housing, hotel and culture. It will link Madou and Saint-Josse. The public space will be completely redesigned, with the creation of a pedestrian area and a new green public space. As a result, surface areas will be optimised and the open-style building layout will provide the necessary fluidity for urban mobility.

Ideally located between the city centre, the North district, the European district, the district which is home to federal and regional institutions and the very busy shopping district of the porte de Namur, this part of the city is well served by all types of public transport and has covered parking spaces open to the public. As a result of this easy accessibility, on Saturdays and sale days, the district's shops and businesses are particularly busy. The commune also has a booming hotel, restaurant and café sector, as well as a large theatre, a conference centre, a nightclub and a jazz club, which means that Saint-Josse is a thriving district, both during the day and at night-time.

Key figures

13,000 visitors a day

2,500 passer-bys per hour
at peak periods

1,2 km from the Grand Place
in Brussels

2 underground lines

11 bus routes

2 bike-sharing stations
(Villo)

2 taxi ranks

2 car-sharing stations
(Cambio)

4 local train stations

540 covered parking
spaces open to the public

3,637 m² of ground
surface area

7,292 m² of built-up
surface area

Contact

Atrium Saint-Josse

Rue des Deux Eglises 131

B-1210 Brussels

Tel : +32-494 57 78 71

Fax : +32-2-280 21 00

Email : stjosse@atrium.irisnet.be

Website : www.meltingshopping.be

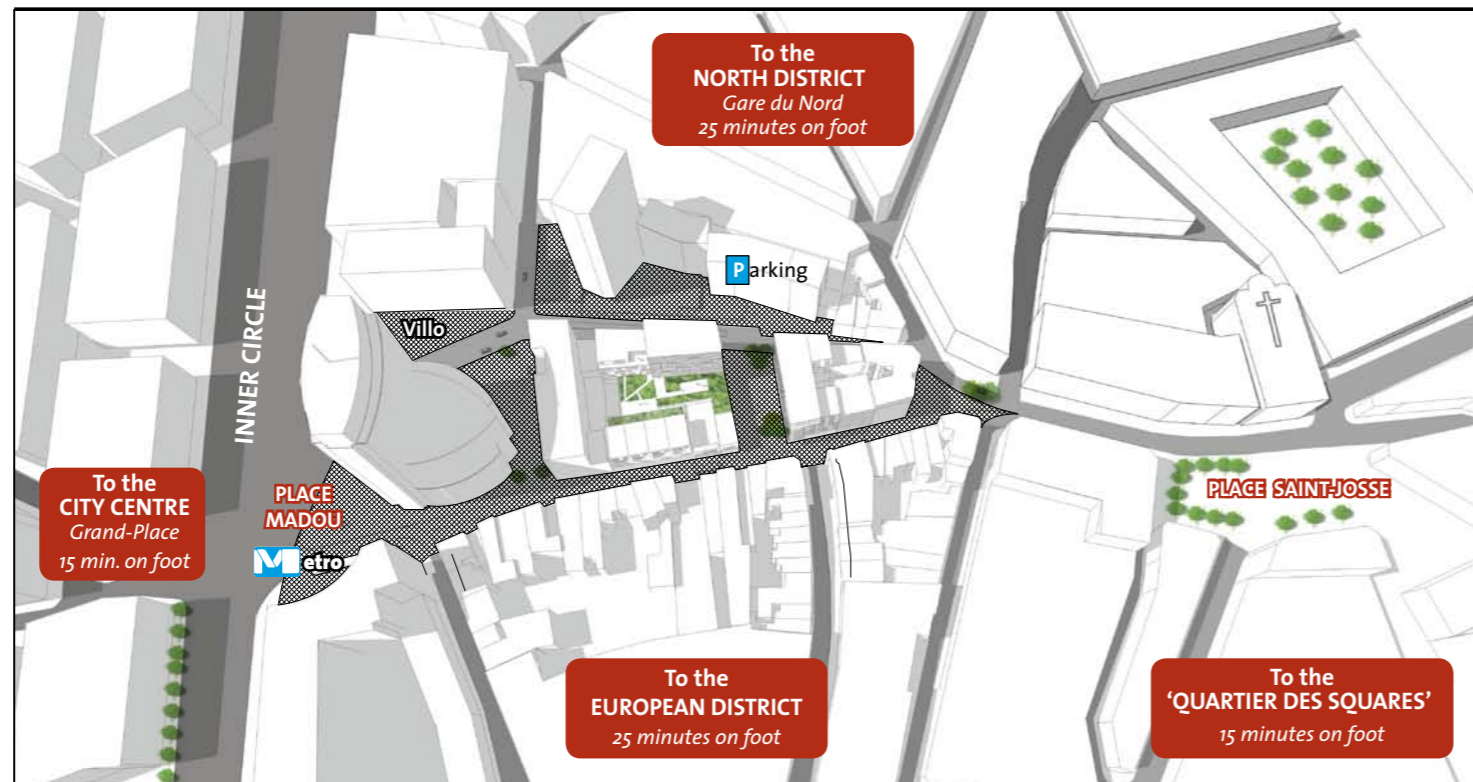

Brussels Madou - Saint-Josse Thriving city life!

